



RUTGERS UNIVERSITY

Hub for Aging Collaboration

School of Social Work

AI-Assisted Tech: Common Practices and Emerging Directions for Age-Friendly Community Leaders

Emily A. Greenfield, PhD, and Natalie E. Pope, MBA, MSSW

Hub for Aging Collaboration at the Rutgers School of Social Work

Lifelong Maine Resource Connect – September 16, 2025

“As more Americans live longer and healthier lives, we need to tap into our national ingenuity, so we can adjust our systems and policies to make the most of this new reality.

- Frameworks Institute

ingenuity



National U.S. Study of Technology Use Among AFC Leaders

- Conducted in partnership with AARP National Livable Communities Team
- Survey conducted in fall 2024 (200+ communities) + Zoom interviews in spring 2025 (13 communities)
- For a fuller presentation of results, register for the AARP Webinar on Tuesday, December 9, 3PM ET
- Today's focus: AI-assistants
 - ChatGPT
 - Microsoft Co-Pilot
 - Plaud AI

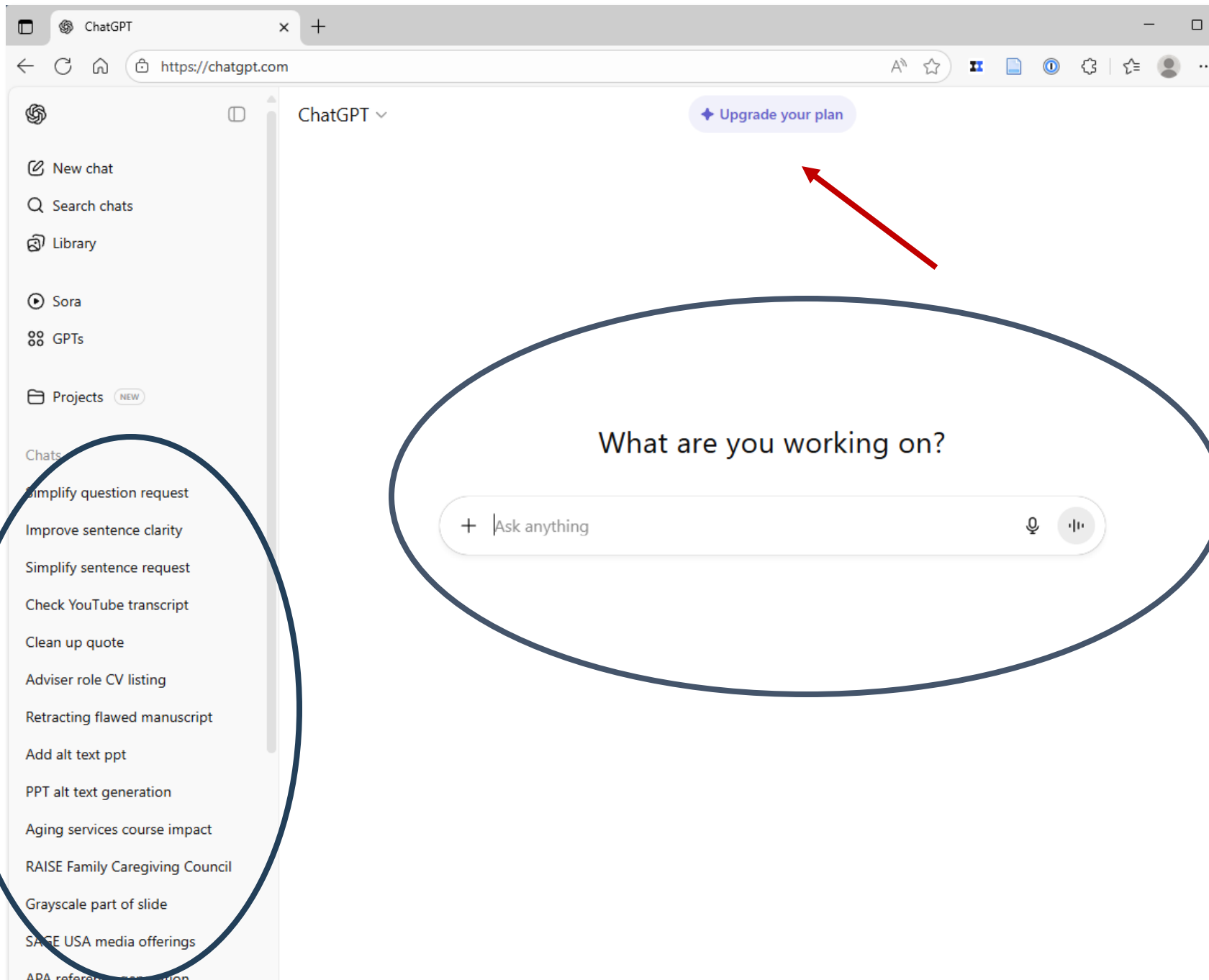

What are AFC leaders typically using AI-assisted technologies for?

Public Communications

- Writing newsletter articles
- Writing social media posts
- Writing press releases
- Creating flyers
- Suggesting catchy titles

GENERATING CONTENT

Internal Communications

- Organizing agendas for AFC meetings
- Generating minutes from AFC meetings
- Preparing oral remarks for AFC meetings
- Summarizing content for grant proposals/reports

What are less
common,
but promising,
uses?

Guiding Strategic Directions

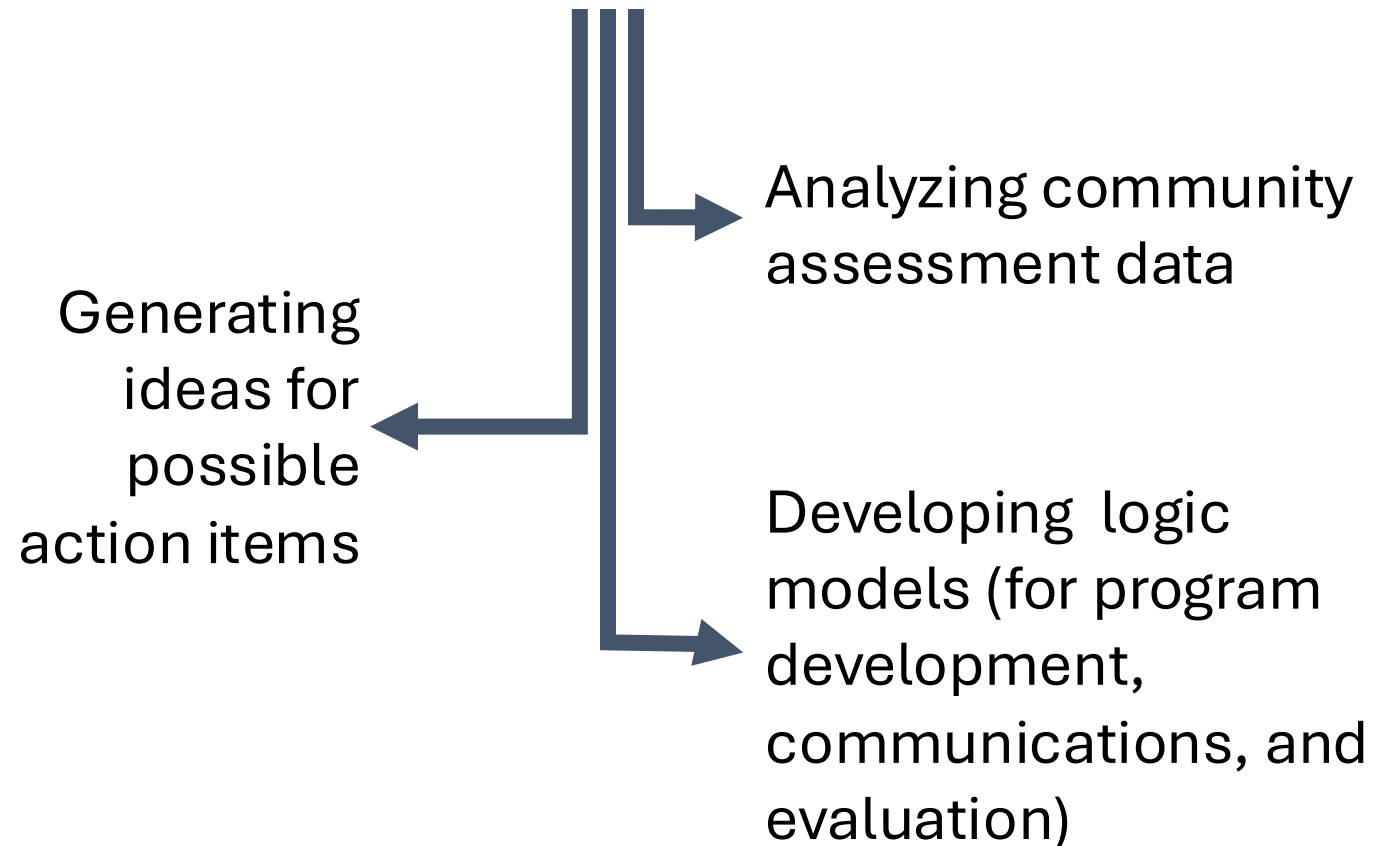

Sample Prompts

#1. What is a small project that a public library can take on to better serve older patrons? Please suggest projects that do not require a large budget nor a new staff position. Please also suggest projects that will make older adults feel more seen and valued by the public library.

#2. What are short- and long-term outcomes of a Careers in Aging Internship Program developed in partnership between a local age-friendly community initiative and a public high school?

Many Caveats

- Tasks never “handed over” to AI without human prompting, oversight, and modification
 - Considerations of accuracy, voice, and authenticity
- Ethical considerations
 - How data are shared and used by AI tech companies
 - AI disclosures
 - Other “big picture” societal concerns
- AI tools as a new area for training and learning (<https://aiandyou.org/>)

Building the Plane as we FLY





RUTGERS UNIVERSITY
Hub for Aging Collaboration
School of Social Work

**THANK
YOU**

Hub for Aging Collaboration
Rutgers School of Social Work

socialwork.rutgers.edu/aging
agingcollab@ssw.rutgers.edu



Follow Us on
LinkedIn



Join Our
Email List